

## Anaconda nickel plated brass fittings for Anaconda Sealrite.

The nickel plated brass Anaconda fittings can be used with all types of Anaconda Sealrite (except CNP). This Anaconda fitting is the most used universal fitting and offers great corrosion protection in combination with a nice appearance. Because of the UL & CSA approvals the fittings are also suitable for export projects outside Europe.

**Construction:** Nickel plated brass fitting, consisting of 4 parts (counter nut, clamping ring, ferrule and body).

**Material:** Counter nut, body and ferrule are nickel plated brass with exception of size 3/8" till 1" where the ferrule is from galvanised steel. Clamping ring and inserts are made

from PA6 (red for ISO metric, blue for Pg and white for NPT).  
**Special approvals:** UL-514B and CSA C 22.2 (combined UL/CSA file # E 234207).

Suitable for use in hazardous environments according NEC 501-4B Class I, Division 2; Class II, Division 1 and 2; Class III, Division 1 and 2.

**Temperature:** -45 °C till +105 °C continuous (cable-hose-fittings are -40 °C till +100 °C).

**Protection class:** IP 67 (dust-proof, water-tight), with cable-hose fittings an IP 68 rate on the switchbox can be obtained. Swivel fittings are limited to IP 65.

**Colour:** Metal.

## ANACONDA FITTINGS

### ISO straight fitting, male, nickel plated brass.

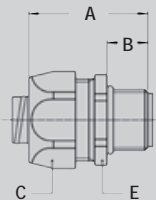

Thread ISO	Sealrite Size (inch)	Min. Internal Bore (mm)	Dimensions in mm					Standard Package	Article Number	Weight (Kg/100)
			A	B	C	D	E			
M12 x 1,5	1/4"	5,2	33	10	22	-	20	50	812.012.1*	4,8
M16 x 1,5	5/16"	8,3	35	12	26	-	24	50	812.015.1*	4,8
M20 x 1,5	5/16"	8,3	36	13	26	-	24	50	812.014.1*	5,1
M16 x 1,5	3/8"	10,2	35	12	26	-	24	50	812.016.1	4,8
M20 x 1,5	3/8"	10,2	36	13	26	-	24	50	812.017.1	5,1
M20 x 1,5	1/2"	13,9	37	13	29	-	27	50	812.020.1	5,9
M25 x 1,5	3/4"	18,5	40	15	35	-	33	25	812.025.1	7,9
M32 x 1,5	1"	23,8	46	15	45	-	43	10	812.032.1	17,5
M40 x 1,5	1.1/4"	31,8	52	16	54	-	52	5	812.040.1	27,9
M50 x 1,5	1.1/2"	36,8	56	18	63	-	60	5	812.050.1	42,3
M63 x 1,5	2"	47,8	66	20	77	-	74	4	812.063.1	73,5
M75 x 1,5	2.1/2"	59,0	72	24	95	-	90	4	812.075.1*	134,4
M90 x 1,5	3"	73,5	80	28	110	-	105	2	812.090.1*	172,8
M105 x 2	4"	94,0	92	32	145	-	135	2	812.105.1*	-

\* Fittings for 1/4", 5/16", 2.1/2", 3" and 4" conduit without UL/CSA approval.

### ISO straight fitting, small design, male, nickel plated brass.

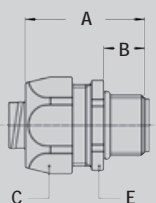

Thread ISO	Sealrite Size (inch)	Min. Internal Bore (mm)	Dimensions in mm					Standard Package	Article Number	Weight (Kg/100)
			A	B	C	D	E			
M12 x 1,5	1/4"	5,2	33	10	19	-	17	50	812.012.2	2,8
M16 x 1,5	1/4"	5,2	35	12	19	-	19	50	812.013.2	3,4
M12 x 1,5	5/16"	8,3	33	10	22	-	20	50	812.011.2	3,6
M16 x 1,5	5/16"	8,3	35	12	22	-	20	50	812.015.2	3,8
M20 x 1,5	5/16"	8,3	36	13	22	-	24	25	812.014.2	4,2



LIQUID-TIGHT  
FITTINGS FOR  
SEALRITE  
IP 67

## ANACONDA FITTINGS

## LIQUID-TIGHT FITTINGS FOR SEALTITE IP 67

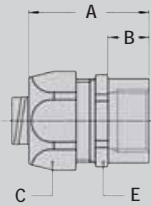

### ISO straight fitting, female, nickel plated brass.



Thread	Sealtite Size (inch)	Min. Internal Bore (mm)	Dimensions in mm					Standard Package	Article Number	Weight (Kg/100)
			A	B	C	D	E			
M16 x 1,5	5/16"	8,3	35	12	26	-	24	50	812.315.1*	5,0
M16 x 1,5	3/8"	10,2	35	12	26	-	24	50	812.316.1	5,0
M20 x 1,5	1/2"	13,9	37	13	29	-	27	50	812.320.1	7,6
M25 x 1,5	3/4"	18,5	40	15	35	-	33	25	812.325.1	9,0
M32 x 1,5	1"	23,8	46	15	45	-	43	10	812.332.1	18,3
M40 x 1,5	1.1/4"	31,8	52	16	54	-	52	5	812.340.1	31,8
M50 x 1,5	1.1/2"	36,8	56	18	63	-	60	5	812.350.1	41,2
M63 x 1,5	2"	47,8	66	20	77	-	74	4	812.363.1	80,0

\* Fittings for 5/16" conduit without UL/CSA approval.

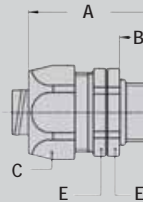

### ISO straight swivel fitting, male, nickel plated brass, IP 65.



Thread	Sealtite Size (inch)	Min. Internal Bore (mm)	Dimensions in mm					Standard Package	Article Number	Weight (Kg/100)
			A	B	C	D	E			
M16 x 1,5	5/16"	8,3	41	12	26	-	24	50	813.015.1	6,8
M16 x 1,5	3/8"	10,2	41	12	26	-	24	50	813.016.1	6,8
M20 x 1,5	1/2"	13,9	43	13	29	-	27	50	813.020.1	8,6
M25 x 1,5	3/4"	18,5	48	15	35	-	33	25	813.025.1	11,6
M32 x 1,5	1"	23,8	54	15	45	-	43	10	813.032.1	27,6
M40 x 1,5	1.1/4"	31,8	-	-	-	-	-	5	813.040.1	-

### ISO 45° fitting, male, nickel plated brass.

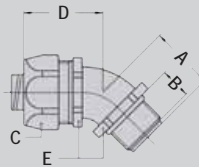

Thread	Sealtite Size (inch)	Min. Internal Bore (mm)	Dimensions in mm					Standard Package	Article Number	Weight (Kg/100)
			A	B	C	D	E			
M16 x 1,5	5/16"	8,3	23	12	26	33	22	50	812.415.1*	7,3
M20 x 1,5	5/16"	8,3	24	13	26	33	22	50	812.414.1*	7,4
M16 x 1,5	3/8"	10,2	23	12	26	33	22	50	812.416.1	7,3
M20 x 1,5	3/8"	10,2	24	13	26	33	22	50	812.417.1	7,4
M20 x 1,5	1/2"	13,9	25	13	29	33	27	50	812.420.1	10,5
M25 x 1,5	3/4"	18,5	30	15	35	36	33	25	812.425.1	13,6
M32 x 1,5	1"	23,8	34	15	45	46	42	10	812.432.1	26,5
M40 x 1,5	1.1/4"	31,8	39	16	54	54	51	5	812.440.1	44,9
M50 x 1,5	1.1/2"	36,8	45	18	63	59	60	5	812.450.1	67,5
M63 x 1,5	2"	47,8	53	20	77	71	74	4	812.463.1	132,9

\* Fittings for 5/16" conduit without UL/CSA approval.

### ISO 90° fitting, male, nickel plated brass.

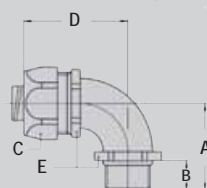

Thread	Sealtite Size (inch)	Min. Internal Bore (mm)	Dimensions in mm					Standard Package	Article Number	Weight (Kg/100)
			A	B	C	D	E			
M16 x 1,5	5/16"	8,3	32	12	26	42	22	50	812.915.1*	9,4
M20 x 1,5	5/16"	8,3	33	13	26	42	22	50	812.914.1*	9,6
M16 x 1,5	3/8"	10,2	32	12	26	42	22	50	812.916.1	9,4
M20 x 1,5	3/8"	10,2	33	13	26	42	22	50	812.917.1	9,6
M20 x 1,5	1/2"	13,9	36	13	29	43	27	50	812.920.1	13,7
M25 x 1,5	3/4"	18,5	43	15	35	48	33	25	812.925.1	16,4
M32 x 1,5	1"	23,8	48	15	45	59	42	10	812.932.1	29,3
M40 x 1,5	1.1/4"	31,8	57	16	54	68	51	5	812.940.1	56,1
M50 x 1,5	1.1/2"	36,8	63	18	63	78	60	5	812.950.1	85,3
M63 x 1,5	2"	47,8	74	20	77	96	74	4	812.963.1	149,8

\* Fittings for 5/16" conduit without UL/CSA approval.



ISO cable-hose fitting, male, nickel plated brass.

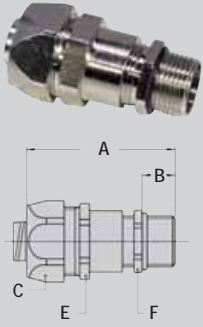

Thread	Sealtite Size (inch)	Clamping Range (mm)	Dimensions in mm					Standard Package	Article Number	Weight (Kg/100)
			A	B	C	E	F			
M16 x 1,5	5/16"	4 - 8	57	12	26	24	18	25	812.715.2	6,0
M16 x 1,5	3/8"	4 - 8	57	12	26	24	18	25	812.716.1	7,8
M20 x 1,5	3/8"	6 - 10,2	57	12	26	24	22	25	812.717.1	9,5
M20 x 1,5	1/2"	6 - 12	59	12	29	27	22	25	812.720.1	9,7
M25 x 1,5	1/2"	10 - 13,9	62	12	29	27	27	25	812.722.1	11,7
M32 x 1,5	3/4"	13 - 18	70	15	35	33	34	25	812.728.1	19,6
M40 x 1,5	1"	18 - 23,8	83	15	45	43	43	10	812.735.1	35,4



ISO, EMC cable-hose fitting, male, nickel plated brass.

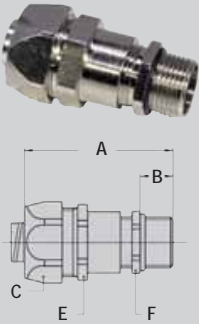

Thread	Sealtite Size (inch)	Clamping Range (mm)	Dimensions in mm					Standard Package	Article Number	Weight (Kg/100)
			A	B	C	E	F			
M16 x 1,5	5/16"	4 - 8	57	12	26	24	18	25	812.615.2	6,0
M16 x 1,5	3/8"	4 - 8	57	12	26	24	18	25	812.616.1	7,8
M20 x 1,5	3/8"	6 - 10,2	57	12	26	24	22	25	812.617.1	9,5
M20 x 1,5	1/2"	6 - 12	59	12	29	27	22	25	812.620.1	9,7
M25 x 1,5	1/2"	10 - 13,9	62	12	29	27	27	25	812.622.1	11,7
M32 x 1,5	3/4"	13 - 18	70	15	35	33	34	25	812.628.1	19,6
M40 x 1,5	1"	18 - 23,8	83	15	45	43	43	10	812.635.1	35,4



Pg straight fitting, male, nickel plated brass.

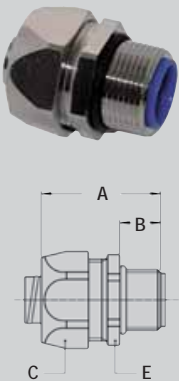

Thread Pg	Sealtite Size (inch)	Min. Internal Bore (mm)	Dimensions in mm					Standard Package	Article Number	Weight (Kg/100)
			A	B	C	D	E			
Pg 7	1/4"	5,2	33	10	22	-	20	50	810.007.1*	3,0
Pg 9	5/16"	8,3	35	12	26	-	24	50	810.009.1*	4,8
Pg 11	5/16"	8,3	35	12	26	-	24	50	810.012.1*	5,6
Pg 13,5	5/16"	8,3	35	12	26	-	24	50	810.014.1*	5,6
Pg 9	3/8"	10,2	35	12	26	-	24	50	810.010.1	4,8
Pg 11	3/8"	10,2	35	12	26	-	24	50	810.011.1	5,6
Pg 13,5	3/8"	10,2	35	12	26	-	24	50	810.013.1	5,6
Pg 16	1/2"	13,9	37	13	29	-	27	50	810.016.1	6,3
Pg 21	3/4"	18,5	40	15	35	-	33	25	810.021.1	8,4
Pg 29	1"	23,8	46	15	45	-	43	10	810.029.1	25,0
Pg 36	1.1/4"	31,8	52	16	54	-	52	5	810.036.1	34,6
Pg 42	1.1/2"	36,8	56	18	63	-	60	5	810.042.1	47,2
Pg 48	2"	47,8	66	20	77	-	74	4	810.048.1	72,0

\* Fittings for 1/4" and 5/16" conduit without UL/CSA approval.



Pg straight fitting, small design, male, nickel plated brass.

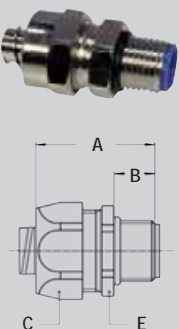

Thread Pg	Sealtite Size (inch)	Min. Internal Bore (mm)	Dimensions in mm					Standard Package	Article Number	Weight (Kg/100)
			A	B	C	D	E			
Pg 7	1/4"	5,2	33	10	19	-	17	50	810.007.2	2,8
Pg 9	5/16"	8,3	35	12	22	-	20	50	810.009.2	3,8

Pg straight fitting, female, nickel plated brass.

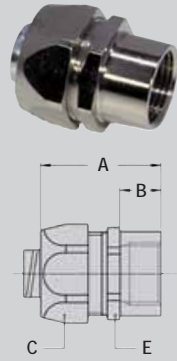

Thread	Sealtite	Min. Internal	Dimensions in mm					Standard	Article	Weight
Pg	Size (inch)	Bore (mm)	A	B	C	D	E	Package	Number	(Kg/100)
Pg 11	5/16"	8,3	35	12	26	-	24	50	810.312.1*	5,0
Pg 13,5	5/16"	8,3	35	12	26	-	24	50	810.314.1*	5,0
Pg 11	3/8"	10,2	35	12	26	-	24	50	810.311.1	5,0
Pg 13,5	3/8"	10,2	35	12	26	-	24	50	810.313.1	5,0
Pg 16	1/2"	13,9	37	13	29	-	27	50	810.316.1	6,3
Pg 21	3/4"	18,5	40	15	35	-	33	25	810.321.1	9,3
Pg 29	1"	23,8	46	15	45	-	43	10	810.329.1	18,1
Pg 36	1.1/4"	31,8	52	16	54	-	52	5	810.336.1	29,3
Pg 42	1.1/2"	36,8	56	18	63	-	60	5	810.342.1	43,2
Pg 48	2"	47,8	66	20	77	-	74	4	810.348.1	74,8

\* Fittings for 5/16" conduit without UL/CSA approval.

Pg straight swivel fitting, male, nickel plated brass, IP 65.

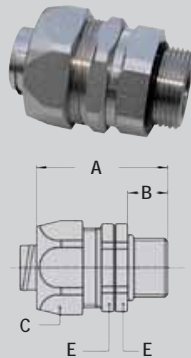

Thread	Sealtite	Min. Internal	Dimensions in mm					Standard	Article	Weight
Pg	Size (inch)	Bore (mm)	A	B	C	D	E	Package	Number	(Kg/100)
Pg 11	5/16"	8,3	41	12	26	-	24	50	811.012.1	6,8
Pg 11	3/8"	10,2	41	12	26	-	24	50	811.011.1	6,8
Pg 16	1/2"	13,9	43	13	29	-	27	50	811.016.1	8,8
Pg 21	3/4"	18,5	48	15	35	-	33	25	811.021.1	13,6
Pg 29	1"	23,8	54	15	45	-	43	10	811.029.1	27,4

Pg 45° fitting, male, nickel plated brass.

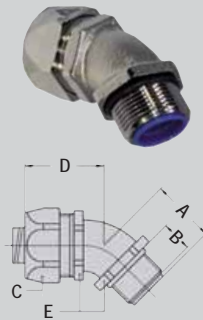

Thread	Sealtite	Min. Internal	Dimensions in mm					Standard	Article	Weight
Pg	Size (inch)	Bore (mm)	A	B	C	D	E	Package	Number	(Kg/100)
Pg 11	5/16"	8,3	23	12	26	33	22	50	810.412.1*	8,1
Pg 13,5	5/16"	8,3	23	12	26	33	22	50	810.414.1*	8,1
Pg 11	3/8"	10,2	23	12	26	33	22	50	810.411.1	8,1
Pg 13,5	3/8"	10,2	23	12	26	33	22	50	810.413.1	8,1
Pg 16	1/2"	13,9	25	13	29	33	27	50	810.416.1	11,6
Pg 21	3/4"	18,5	30	15	35	36	33	25	810.421.1	15,3
Pg 29	1"	23,8	34	15	45	46	42	10	810.429.1	31,5
Pg 36	1.1/4"	31,8	39	16	54	54	51	5	810.436.1	53,2
Pg 42	1.1/2"	36,8	45	18	63	59	60	5	810.442.1	78,5
Pg 48	2"	47,8	53	20	77	71	74	4	810.448.1	126,7

\* Fittings for 5/16" conduit without UL/CSA approval.

Pg 90° fitting, male, nickel plated brass.

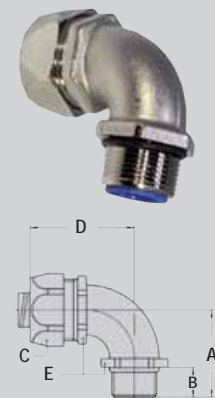

Thread	Sealtite	Min. Internal	Dimensions in mm					Standard	Article	Weight
Pg	Size (inch)	Bore (mm)	A	B	C	D	E	Package	Number	(Kg/100)
Pg 11	5/16"	8,3	32	12	26	42	22	50	810.912.1*	8,9
Pg 13,5	5/16"	8,3	32	12	26	42	22	50	810.914.1*	8,9
Pg 11	3/8"	10,2	32	12	26	42	22	50	810.911.1	8,9
Pg 13,5	3/8"	10,2	32	12	26	42	22	50	810.913.1	8,9
Pg 16	1/2"	13,9	36	13	29	43	27	50	810.916.1	15,3
Pg 21	3/4"	18,5	43	15	35	48	33	25	810.921.1	21,6
Pg 29	1"	23,8	48	15	45	59	42	10	810.929.1	35,3
Pg 36	1.1/4"	31,8	57	16	54	68	51	5	810.936.1	62,5
Pg 42	1.1/2"	36,8	63	18	63	78	60	5	810.942.1	88,1
Pg 48	2"	47,8	74	20	77	96	74	4	810.948.1	141,9

\* Fittings for 5/16" conduit without UL/CSA approval.

ANACONDA FITTINGS

LIQUID-TIGHT FITTINGS FOR SEALTITE IP 67



**Pg cable-hose fitting, male, nickel plated brass.**

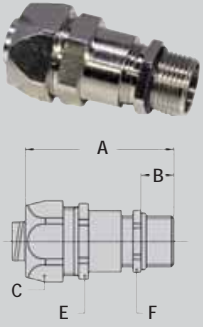

Thread	Sealtite	Clamping	Dimensions in mm					Standard	Article	Weight
Pg	Size (inch)	Range (mm)	A	B	C	E	F	Package	Number	(Kg/100)
Pg 9	5/16"	4 - 8	55	10	26	24	17	25	810.709.1	7,8
Pg 9	3/8"	5 - 8	55	10	26	24	20	25	810.712.1	7,8
Pg 11	3/8"	5 - 10	55	10	26	24	20	25	810.711.1	9,5
Pg 13,5	1/2"	6 - 12	57	10	29	27	22	25	810.715.1	9,7
Pg 16	1/2"	10 - 13,9	60	10	29	27	24	25	810.716.1	11,7
Pg 21	3/4"	13 - 18	67	12	35	33	30	25	810.721.1	19,6
Pg 29	1"	18 - 23,8	80	12	45	43	40	10	810.729.1	35,4



**Pg, EMC cable-hose fitting, male, nickel plated brass.**

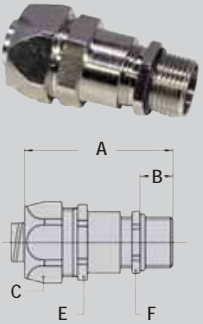

Thread	Sealtite	Clamping	Dimensions in mm					Standard	Article	Weight
Pg	Size (inch)	Range (mm)	A	B	C	E	F	Package	Number	(Kg/100)
Pg 9	5/16"	4 - 8	55	10	26	24	17	25	810.609.1	7,8
Pg 9	3/8"	5 - 8	55	10	26	24	20	25	810.612.1	7,8
Pg 11	3/8"	5 - 10	55	10	26	24	20	25	810.611.1	9,5
Pg 13,5	1/2"	6 - 12	57	10	29	27	22	25	810.615.1	9,7
Pg 16	1/2"	10 - 13,9	60	10	29	27	24	25	810.616.1	11,7
Pg 21	3/4"	13 - 18	67	12	35	33	30	25	810.621.1	19,6
Pg 29	1"	18 - 23,8	80	12	45	43	40	10	810.629.1	35,4



**NPT straight fitting, male, nickel plated brass.**

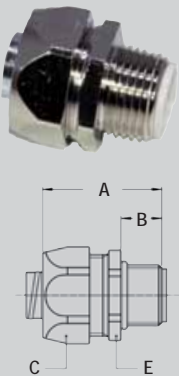

Thread	Sealtite	Min. Internal	Dimensions in mm					Standard	Article	Weight
NPT	Size (inch)	Bore (mm)	A	B	C	D	E	Package	Number	(Kg/100)
1/2" NPT	5/16"	8,3	35	12	26	-	24	50	814.011.1*	5,6
1/2" NPT	3/8"	10,2	35	12	26	-	24	50	814.012.1	5,6
1/2" NPT	1/2"	13,9	37	13	29	-	27	50	814.016.1	6,2
3/4" NPT	3/4"	18,5	40	15	35	-	33	25	814.020.1	8,9
1" NPT	1"	23,8	46	15	45	-	43	10	814.026.1	17,9
1.1/4" NPT	1.1/4"	31,8	52	16	54	-	52	5	814.035.1	40,0
1.1/2" NPT	1.1/2"	36,8	56	18	63	-	60	5	814.040.1	43,8
2" NPT	2"	47,8	66	20	77	-	74	4	814.050.1	73,5
2.1/2" NPT	2.1/2"	59,0	72	24	95	-	90	4	814.063.1*	-
3" NPT	3"	71,5	80	28	110	-	105	2	814.075.1*	-
4" NPT	4"	96,0	92	32	145	-	135	2	814.099.1*	-

\* Fittings for 1/4", 5/16", 2.1/2", 3" and 4" conduit without UL/CSA approval.



**NPT straight fitting, female, nickel plated brass.**

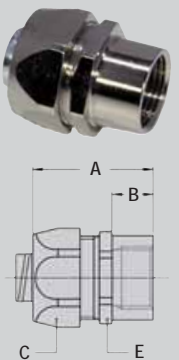

Thread	Sealtite	Min. Internal	Dimensions in mm					Standard	Article	Weight
NPT	Size (inch)	Bore (mm)	A	B	C	D	E	Package	Number	(Kg/100)
1/2" NPT	5/16"	8,3	37	13	26	-	24	50	814.311.1*	5,3
1/2" NPT	3/8"	10,2	37	13	26	-	24	50	814.312.1	5,3
1/2" NPT	1/2"	13,9	37	13	29	-	27	50	814.316.1	6,2
3/4" NPT	3/4"	18,5	40	15	35	-	33	25	814.320.1	9,0
1" NPT	1"	23,8	46	15	45	-	43	10	814.326.1	20,7
1.1/4" NPT	1.1/4"	31,8	52	16	54	-	52	5	814.335.1	29,3
1.1/2" NPT	1.1/2"	36,8	56	18	63	-	60	5	814.340.1	43,8
2" NPT	2"	47,8	66	20	77	-	74	4	814.350.1	73,3

\* Fittings for 5/16" conduit without UL/CSA approval.

NPT 45° fitting, male, nickel plated brass.

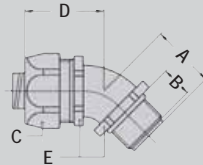

Thread NPT	Sealtite Size (inch)	Min. Internal Bore (mm)	Dimensions in mm					Standard Package	Article Number	Weight (Kg/100)
			A	B	C	D	E			
1/2" NPT	5/16"	8,3	23	12	26	33	22	50	814.411.1*	7,9
1/2" NPT	3/8"	10,2	23	12	26	33	22	50	814.412.1	7,9
1/2" NPT	1/2"	13,9	25	13	29	33	27	50	814.416.1	10,7
3/4" NPT	3/4"	18,5	30	15	35	36	33	25	814.420.1	15,7
1" NPT	1"	23,8	34	15	45	46	42	10	814.426.1	26,5
1.1/4" NPT	1.1/4"	31,8	39	16	54	54	51	5	814.435.1	45,2
1.1/2" NPT	1.1/2"	36,8	45	18	63	59	60	5	814.440.1	69,1
2" NPT	2"	47,8	53	20	77	71	74	4	814.450.1	100,1

\* Fittings for 5/16" conduit without UL/CSA approval.

NPT 90° fitting, male, nickel plated brass.

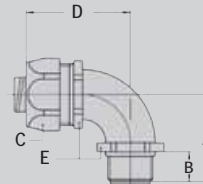

Thread NPT	Sealtite Size (inch)	Min. Internal Bore (mm)	Dimensions in mm					Standard Package	Article Number	Weight (Kg/100)
			A	B	C	D	E			
1/2" NPT	5/16"	8,3	32	12	26	42	22	50	814.911.1*	13,3
1/2" NPT	3/8"	10,2	32	12	26	42	22	50	814.912.1	13,3
1/2" NPT	1/2"	13,9	36	13	29	43	27	50	814.916.1	14,6
3/4" NPT	3/4"	18,5	43	15	35	48	33	25	814.920.1	22,0
1" NPT	1"	23,8	48	15	45	59	42	10	814.926.1	31,7
1.1/4" NPT	1.1/4"	31,8	57	16	54	68	51	5	814.935.1	62,5
1.1/2" NPT	1.1/2"	36,8	63	18	63	78	60	5	814.940.1	89,1
2" NPT	2"	47,8	74	20	77	96	74	4	814.950.1	141,9

\* Fittings for 5/16" conduit without UL/CSA approval.

NPT cable-hose fitting, male, nickel plated brass.

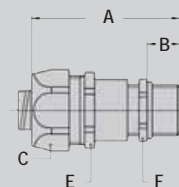

Thread NPT	Sealtite Size (inch)	Clamping Range (mm)	Dimensions in mm					Standard Package	Article Number	Weight (Kg/100)
			A	B	C	E	F			
3/8" NPT	5/16"	4 - 8	60	15	26	24	17	25	814.709.1	7,8
3/8" NPT	3/8"	4 - 8	60	15	26	24	17	25	814.710.1	7,8
1/2" NPT	3/8"	6 - 10	57	13	26	24	22	25	814.712.1	11,7
1/2" NPT	1/2"	6 - 12	59	13	29	27	22	25	814.715.1	11,7
3/4" NPT	3/4"	13 - 18	68	13	35	33	30	25	814.721.1	19,6

ANACONDA  
FITTINGS

LIQUID-TIGHT  
FITTINGS FOR  
SEALTITE  
IP 67



### Grounding ferrule, zinc plated steel.



Thread	Sealrite	Min. Internal Bore (mm)	Dimensions in mm					Standard Package	Article Number	Weight (Kg/100)
	Size (inch)		A	B	C	D	E			
-	3/8"	10,2	-	-	-	-	-	25	815.011.0	-
-	1/2"	13,9	-	-	-	-	-	25	815.016.0	-
-	3/4"	18,5	-	-	-	-	-	25	815.021.0	-
-	1"	23,8	-	-	-	-	-	5	815.029.0	-



### Grounding ferrule, nickel plated brass.



Thread	Sealrite	Min. Internal Bore (mm)	Dimensions in mm					Standard Package	Article Number	Weight (Kg/100)
	Size (inch)		A	B	C	D	E			
-	1/4"	5,2	-	-	-	-	-	25	815.006.0	-
-	5/16"	8,3	-	-	-	-	-	25	815.010.0	-
-	3/8"	10,2	-	-	-	-	-	25	815.011.4	-
-	1/2"	13,9	-	-	-	-	-	25	815.016.4	-
-	3/4"	18,5	-	-	-	-	-	25	815.021.4	-
-	1"	23,8	-	-	-	-	-	5	815.029.4	-
-	1.1/4"	31,8	-	-	-	-	-	5	815.036.0	-
-	1.1/2"	36,8	-	-	-	-	-	5	815.042.0	-
-	2"	47,8	-	-	-	-	-	2	815.048.0	-



### Neoprene Sealing gasket for ISO / Pg / NPT.



Thread ISO	Thread Pg	Thread NPT	Dimensions in mm					Standard Package	Article Number	Weight (Kg/100)
			A	B	C	D	E			
-	Pg 7	-	-	-	-	-	-	100	815.507.0	-
M16 x 1,5	Pg 9	-	-	-	-	-	-	100	815.509.0	-
-	Pg 11	-	-	-	-	-	-	100	815.511.0	-
M20 x 1,5	Pg 13,5	-	-	-	-	-	-	100	815.513.0	-
-	Pg 16	NPT 1/2"	-	-	-	-	-	100	815.516.0	-
M25 x 1,5	Pg 21	NPT 3/4"	-	-	-	-	-	50	815.521.0	-
M32 x 1,5	Pg 29	NPT 1"	-	-	-	-	-	50	815.529.0	-
-	Pg 36	NPT 1.1/4"	-	-	-	-	-	50	815.536.0	-
-	Pg 42	NPT 1.1/2"	-	-	-	-	-	50	815.542.0	-
-	Pg 48	NPT 2"	-	-	-	-	-	50	815.548.0	-



### Lock nuts, nickel plated brass, ISO.



Thread ISO	Sealrite Size (inch)	Min. Internal Bore (mm)	Dimensions in mm					Standard Package	Article Number	Weight (Kg/100)
			A	B	C	D	E			
M12 x 1,5	-	-	-	-	-	-	-	50	880.112.0	-
M16 x 1,5	-	-	-	-	-	-	-	50	880.116.0	-
M20 x 1,5	-	-	-	-	-	-	-	50	880.120.0	-
M25 x 1,5	-	-	-	-	-	-	-	25	880.125.0	-
M32 x 1,5	-	-	-	-	-	-	-	20	880.132.0	-
M40 x 1,5	-	-	-	-	-	-	-	10	880.140.0	-
M50 x 1,5	-	-	-	-	-	-	-	10	880.150.0	-
M63 x 1,5	-	-	-	-	-	-	-	5	880.163.0	-

### Lock nuts, nickel plated brass, Pg.



Thread Pg	Sealtite Size (inch)	Min. Internal Bore (mm)	Dimensions in mm					Standard Package	Article Number	Weight (Kg/100)
			A	B	C	D	E			
Pg 7	-	-	-	-	-	-	-	50	880.007.0	-
Pg 9	-	-	-	-	-	-	-	50	880.009.0	-
Pg 11	-	-	-	-	-	-	-	50	880.011.0	-
Pg 13,5	-	-	-	-	-	-	-	50	880.013.0	-
Pg 16	-	-	-	-	-	-	-	50	880.016.0	-
Pg 21	-	-	-	-	-	-	-	20	880.021.0	-
Pg 29	-	-	-	-	-	-	-	20	880.029.0	-
Pg 36	-	-	-	-	-	-	-	10	880.036.0	-
Pg 42	-	-	-	-	-	-	-	5	880.042.0	-
Pg 48	-	-	-	-	-	-	-	5	880.048.0	-

### Lock nuts, nickel plated brass, NPT.



Thread NPT	Sealtite Size (inch)	Min. Internal Bore (mm)	Dimensions in mm					Standard Package	Article Number	Weight (Kg/100)
			A	B	C	D	E			
NPT 1/2"	-	-	-	-	-	-	-	50	880.216.0	-
NPT 3/4"	-	-	-	-	-	-	-	50	880.220.0	-
NPT 1"	-	-	-	-	-	-	-	25	880.226.0	-
NPT 1.1/4"	-	-	-	-	-	-	-	25	880.235.0	-
NPT 1.1/2"	-	-	-	-	-	-	-	10	880.240.0	-
NPT 2"	-	-	-	-	-	-	-	10	880.250.0	-

### Pg / Pg enlargers, nickel plated brass.



Outside Thread	Inside Thread	Min. Internal Bore (mm)	Dimensions in mm					Standard Package	Article Number	Weight (Kg/100)
			A	B	C	D	E			
Pg 7	Pg 9	-	-	-	-	-	-	50	882.009.0	-
Pg 9	Pg 11	-	-	-	-	-	-	50	882.011.0	-
Pg 9	Pg 13,5	-	-	-	-	-	-	50	882.012.0	-
Pg 11	Pg 13,5	-	-	-	-	-	-	50	882.013.0	-
Pg 11	Pg 16	-	-	-	-	-	-	25	882.016.0	-
Pg 13,5	Pg 16	-	-	-	-	-	-	25	882.017.0	-
Pg 13,5	Pg 21	-	-	-	-	-	-	20	882.018.0	-
Pg 16	Pg 21	-	-	-	-	-	-	20	882.021.0	-
Pg 21	Pg 29	-	-	-	-	-	-	15	882.029.0	-
Pg 29	Pg 36	-	-	-	-	-	-	10	882.036.0	-
Pg 36	Pg 42	-	-	-	-	-	-	10	882.042.0	-
Pg 42	Pg 48	-	-	-	-	-	-	10	882.048.0	-

### Pg / ISO adapter, nickel plated brass.



Outside Thread	Inside Thread	Min. Internal Bore (mm)	Dimensions in mm					Standard Package	Article Number	Weight (Kg/100)
			A	B	C	D	E			
Pg 11	M16 x 1,5	-	-	-	-	-	-	50	882.111.0	-
Pg 16	M20 x 1,5	-	-	-	-	-	-	50	882.116.0	-
Pg 21	M25 x 1,5	-	-	-	-	-	-	20	882.121.0	-
Pg 29	M32 x 1,5	-	-	-	-	-	-	20	882.129.0	-
Pg 36	M40 x 1,5	-	-	-	-	-	-	10	882.136.0	-
Pg 48	M50 x 1,5	-	-	-	-	-	-	5	882.148.0	-

ANACONDA  
FITTINGS

ACCESSORIES





Pg / Pg reducer, nickel plated brass.



Outside Thread	Inside Thread	Min. Internal Bore (mm)	Dimensions in mm					Standard Package	Article Number	Weight (Kg/100)
			A	B	C	D	E			
Pg 9	Pg 7	-	-	-	-	-	-	100	881.007.0	-
Pg 11	Pg 7	-	-	-	-	-	-	100	881.008.0	-
Pg 11	Pg 9	-	-	-	-	-	-	100	881.009.0	-
Pg 13,5	Pg 9	-	-	-	-	-	-	100	881.010.0	-
Pg 13,5	Pg 11	-	-	-	-	-	-	100	881.011.0	-
Pg 16	Pg 11	-	-	-	-	-	-	100	881.012.0	-
Pg 16	Pg 13,5	-	-	-	-	-	-	100	881.013.0	-
Pg 21	Pg 13,5	-	-	-	-	-	-	50	881.015.0	-
Pg 21	Pg 16	-	-	-	-	-	-	50	881.016.0	-
Pg 29	Pg 21	-	-	-	-	-	-	25	881.021.0	-
Pg 36	Pg 29	-	-	-	-	-	-	25	881.029.0	-
Pg 42	Pg 36	-	-	-	-	-	-	25	881.036.0	-
Pg 48	Pg 42	-	-	-	-	-	-	25	881.042.0	-



ISO / ISO enlarger, nickel plated brass.



Outside Thread	Inside Thread	Min. Internal Bore (mm)	Dimensions in mm					Standard Package	Article Number	Weight (Kg/100)
			A	B	C	D	E			
M12 x 1,5	M16 x 1,5	-	-	-	-	-	-	50	881.216.0	-
M16 x 1,5	M20 x 1,5	-	-	-	-	-	-	50	881.220.0	-
M20 x 1,5	M25 x 1,5	-	-	-	-	-	-	50	881.225.0	-
M25 x 1,5	M32 x 1,5	-	-	-	-	-	-	20	881.232.0	-
M32 x 1,5	M40 x 1,5	-	-	-	-	-	-	20	881.240.0	-
M40 x 1,5	M50 x 1,5	-	-	-	-	-	-	10	881.250.0	-
M50 x 1,5	M63 x 1,5	-	-	-	-	-	-	5	881.263.0	-



ISO / Pg adapter, nickel plated brass.



Outside Thread	Inside Thread	Min. Internal Bore (mm)	Dimensions in mm					Standard Package	Article Number	Weight (Kg/100)
			A	B	C	D	E			
M12 x 1,5	Pg 7	-	-	-	-	-	-	100	881.107.0	-
M16 x 1,5	Pg 9	-	-	-	-	-	-	50	881.109.0	-
M20 x 1,5	Pg 11	-	-	-	-	-	-	50	881.111.0	-
M25 x 1,5	Pg 16	-	-	-	-	-	-	50	881.116.0	-
M32 x 1,5	Pg 21	-	-	-	-	-	-	20	881.121.0	-
M40 x 1,5	Pg 29	-	-	-	-	-	-	10	881.129.0	-
M50 x 1,5	Pg 36	-	-	-	-	-	-	10	881.136.0	-
M63 x 1,5	Pg 48	-	-	-	-	-	-	1	881.148.0	-



ISO / ISO reducer, nickel plated brass.



Outside Thread	Inside Thread	Min. Internal Bore (mm)	Dimensions in mm					Standard Package	Article Number	Weight (Kg/100)
			A	B	C	D	E			
M16 x 1,5	M12 x 1,5	-	-	-	-	-	-	50	882.212.0	-
M20 x 1,5	M16 x 1,5	-	-	-	-	-	-	50	882.216.0	-
M25 x 1,5	M20 x 1,5	-	-	-	-	-	-	20	882.220.0	-
M32 x 1,5	M25 x 1,5	-	-	-	-	-	-	20	882.225.0	-
M40 x 1,5	M32 x 1,5	-	-	-	-	-	-	10	882.232.0	-
M50 x 1,5	M40 x 1,5	-	-	-	-	-	-	5	882.240.0	-
M63 x 1,5	M50 x 1,5	-	-	-	-	-	-	1	882.250.0	-

### NPT / Pg adapter, nickel plated brass.



Outside Thread	Inside Thread	Min. Internal Bore (mm)	Dimensions in mm					Standard Package	Article Number	Weight (Kg/100)
			A	B	C	D	E			
NPT 1/2"	Pg 9	-	-	-	-	-	-	50	882.309.0	-
NPT 1/2"	Pg 11	-	-	-	-	-	-	50	882.311.0	-
NPT 1/2"	Pg 13,5	-	-	-	-	-	-	50	882.313.0	-
NPT 1/2"	Pg 16	-	-	-	-	-	-	50	882.316.0	-
NPT 3/4"	Pg 21	-	-	-	-	-	-	50	882.321.0	-
NPT 1"	Pg 21	-	-	-	-	-	-	20	882.326.0	-
NPT 1"	Pg 29	-	-	-	-	-	-	20	882.329.0	-
NPT 1.1/4"	Pg 29	-	-	-	-	-	-	20	882.330.0	-
NPT 1.1/4"	Pg 36	-	-	-	-	-	-	20	882.336.0	-
NPT 1.1/2"	Pg 36	-	-	-	-	-	-	10	882.340.0	-
NPT 1.1/2"	Pg 42	-	-	-	-	-	-	5	882.342.0	-
NPT 2"	Pg 48	-	-	-	-	-	-	5	882.348.0	-

### Pg / NPT adapter, nickel plated brass.



Outside Thread	Inside Thread	Min. Internal Bore (mm)	Dimensions in mm					Standard Package	Article Number	Weight (Kg/100)
			A	B	C	D	E			
Pg 9	NPT 1/2"	-	-	-	-	-	-	50	882.410.0	-
Pg 11	NPT 3/8"	-	-	-	-	-	-	50	882.411.0	-
Pg 11	NPT 1/2"	-	-	-	-	-	-	50	882.412.0	-
Pg 13,5	NPT 1/2"	-	-	-	-	-	-	50	882.413.0	-
Pg 16	NPT 1/2"	-	-	-	-	-	-	50	882.416.0	-
Pg 21	NPT 3/4"	-	-	-	-	-	-	20	882.420.0	-
Pg 29	NPT 1.1/4"	-	-	-	-	-	-	20	882.435.0	-
Pg 36	NPT 1.1/2"	-	-	-	-	-	-	10	882.440.0	-
Pg 48	NPT 2"	-	-	-	-	-	-	5	882.450.0	-

### NPT / ISO adapter, nickel plated brass.



Outside Thread	Inside Thread	Min. Internal Bore (mm)	Dimensions in mm					Standard Package	Article Number	Weight (Kg/100)
			A	B	C	D	E			
NPT 1/2"	M16 x 1,5	-	-	-	-	-	-	50	882.516.0	-
NPT 1/2"	M20 x 1,5	-	-	-	-	-	-	50	882.520.0	-
NPT 1/2"	M25 x 1,5	-	-	-	-	-	-	50	882.522.0	-
NPT 3/4"	M20 x 1,5	-	-	-	-	-	-	50	882.524.0	-
NPT 3/4"	M25 x 1,5	-	-	-	-	-	-	50	882.525.0	-
NPT 3/4"	M32 x 1,5	-	-	-	-	-	-	10	882.527.0	-
NPT 1"	M25 x 1,5	-	-	-	-	-	-	20	882.528.0	-
NPT 1"	M32 x 1,5	-	-	-	-	-	-	20	882.532.0	-
NPT 1.1/4"	M25 x 1,5	-	-	-	-	-	-	20	882.536.0	-
NPT 1.1/4"	M32 x 1,5	-	-	-	-	-	-	10	882.538.0	-
NPT 1.1/4"	M40 x 1,5	-	-	-	-	-	-	20	882.540.0	-
NPT 1.1/2"	M40 x 1,5	-	-	-	-	-	-	1	882.548.0	-
NPT 1.1/2"	M50 x 1,5	-	-	-	-	-	-	1	882.550.0	-
NPT 1.1/2"	M63 x 1,5	-	-	-	-	-	-	1	882.552.0	-
NPT 2"	M50 x 1,5	-	-	-	-	-	-	1	882.560.0	-
NPT 2"	M63 x 1,5	-	-	-	-	-	-	1	882.563.0	-

ANACONDA  
FITTINGS

ACCESSORIES

### ISO / NPT adapter, nickel plated brass.



Outside Thread	Inside Thread	Min. Internal Bore (mm)	Dimensions in mm					Standard Package	Article Number	Weight (Kg/100)
			A	B	C	D	E			
M16 x 1,5	NPT 1/2"	-	-	-	-	-	-	50	882.612.0	-
M20 x 1,5	NPT 1/2"	-	-	-	-	-	-	50	882.616.0	-
M25 x 1,5	NPT 3/4"	-	-	-	-	-	-	20	882.620.0	-
M32 x 1,5	NPT 1"	-	-	-	-	-	-	5	882.635.0	-



### Neoprene, end cap, with strain relief, IP 54.



Thread	Sealrite Size (inch)	Clamping Range (mm)	Dimensions in mm					Standard Package	Article Number	Weight (Kg/100)
			A	B	C	D	E			
-	3/8"	4 - 9	-	-	-	-	-	3000	266.812.0	-
-	1/2"	5 - 12	-	-	-	-	-	2400	266.817.0	-
-	3/4"	7 - 17	-	-	-	-	-	1200	266.823.0	-
-	1"	9 - 20	-	-	-	-	-	800	266.829.0	-
-	1.1/4"	16 - 30	-	-	-	-	-	800	266.836.0	-



### 90° elbow, ISO, inside / outside thread, zinc die cast.



Outside Thread	Inside Thread	Min. Internal Bore (mm)	Dimensions in mm					Standard Package	Article Number	Weight (Kg/100)
			A	B	C	D	E			
M12 x 1,5	M12 x 1,5	-	-	-	-	-	-	25	883.112.0	-
M16 x 1,5	M16 x 1,5	-	-	-	-	-	-	25	883.160.0	-
M20 x 1,5	M20 x 1,5	-	-	-	-	-	-	25	883.119.0	-
M25 x 1,5	M25 x 1,5	-	-	-	-	-	-	20	883.125.0	-
M32 x 1,5	M32 x 1,5	-	-	-	-	-	-	10	883.132.0	-
M40 x 1,5	M40 x 1,5	-	-	-	-	-	-	5	883.140.0	-



### 90° elbow, Pg, inside / outside thread, zinc die cast.



Outside Thread	Inside Thread	Min. Internal Bore (mm)	Dimensions in mm					Standard Package	Article Number	Weight (Kg/100)
			A	B	C	D	E			
Pg 7	Pg 7	-	-	-	-	-	-	100	883.107.0	-
Pg 9	Pg 9	-	-	-	-	-	-	100	883.109.0	-
Pg 11	Pg 11	-	-	-	-	-	-	50	883.111.0	-
Pg 13,5	Pg 13,5	-	-	-	-	-	-	50	883.113.0	-
Pg 16	Pg 16	-	-	-	-	-	-	50	883.116.0	-
Pg 21	Pg 21	-	-	-	-	-	-	25	883.121.0	-
Pg 29	Pg 29	-	-	-	-	-	-	10	883.129.0	-
Pg 36	Pg 36	-	-	-	-	-	-	5	883.136.0	-



### Swivel adapter, ISO, inside / outside thread, nickel plated brass.

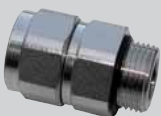

Outside Thread	Inside Thread	Min. Internal Bore (mm)	Dimensions in mm					Standard Package	Article Number	Weight (Kg/100)
			A	B	C	D	E			
M16 x 1,5	M16 x 1,5	-	-	-	-	-	-	50	885.216.0	-
M20 x 1,5	M20 x 1,5	-	-	-	-	-	-	50	885.220.0	-
M25 x 1,5	M25 x 1,5	-	-	-	-	-	-	25	885.225.0	-
M32 x 1,5	M32 x 1,5	-	-	-	-	-	-	10	885.232.0	-
M40 x 1,5	M40 x 1,5	-	-	-	-	-	-	5	885.240.0	-